



Grassroots 2005

Underground in Washington DC

AIA London President Jim Baker and Michael Lisher, in his capacity as a recently appointed member of the Institute's International Task Force, attended the Grassroots Conference over four bleak days in February. The conference took place in the overwhelmingly dreary third basement of the Grand Hyatt in Washington. Grassroots



provides the opportunity for chapter presidents, presidents-elect and chapter executives to meet in order to learn more about the operations and services of the Institute and to participate in "Advocacy Day" a day where chapter officers meet with their respective legislators. It is also an opportunity to attend classes of chapter interest, such as "Maximising Your Component's Non-Dues Revenue" and general knowledge lectures such as "Ecological Literacy in Architectural Education". We attended a mix of lectures and, perhaps not surprisingly, found some well presented and others lacklustre. There were many general session events most of which seemed a sameness and a number of friendly social events including a "Gala" in the Old Pension Building.

The most interesting and worthwhile aspect of the conference was a meeting with representatives of the Institute (arranged by us) and the three international chapters; London, Continental Europe and Hong Kong. The two main topics were recognition and representation. The point being that the overseas chapters and their members, while in our opinion, playing a role of far more importance to the Institute than mere numbers would suggest, are neither truly recognised by the Institute nor represented on the Board. The three international chapters are generally unanimous in their negative opinions regarding this situation. However, on the positive side, in part because of the meeting, we have reason to believe that the Institute will make the internal bye-law changes necessary to rectify this situation. We will continue to lobby on this subject.

In summary while we think Grassroots 2005 deserves a mixed review, it remains an essential element of the Institute's annual events and is important to attend.

Jim Baker



Billed as one of the great new spaces of London, the Bar and Restaurant in the 'nose' of St Mary's Axe is the location for the AIA London / UK's Annual Summer Social Event.

upcoming events

AIA London DESIGN AWARDS

Thursday 22nd March

Location, Royal Society of Arts

Time, 6:15 PM for 7 PM awards

Reception to follow

Article Pg 2

ARCHITECTURE at the V&A

Wednesday 13th April

Location, V&A

Time, 7 PM

RSVP at info@aia.org

See Pg 3

FOOT Tour "timber-framed buildings that survived the GREAT FIRE"

Saturday 11th June

Location, St Bartholomew the

Great Church, Smithfield London

Time, 11 AM

RSVP at info@aia.org

See Pg 3

Summer SKY HIGH Social

Date to be confirmed

Location, 30 St. Mary's Axe

Time, Weekday Eve

Info available on web site in April

AIA London /UK
Ben Franklin House
36 Craven Street
London WC2N 5NF
t: 020.7930.9124
e: info@aiauk.org
w: www.aiauk.org

The 11th Annual AIA London / UK Excellence in Design Awards Programme

One of the biggest Chapter events of the year is scheduled for Tuesday 22nd March when the AIA London Design Awards will be presented at the Royal Society of Arts. The doors open at 6:15 PM for drinks, followed by the Awards presentation is at 7PM, followed by a reception (more drinks and light food). Each award winner will be given up to 10 minutes to present their winning project. Typically 4 to 5 winning projects are named. There is no admission charge for this event, which draws a crowd in excess of 150 including representatives from the AIA, RIBA, students and professional media.



1



2



3



4

We believe our Awards are highly valued by architects because they confer a trans-Atlantic dimension to recognition of their achievements. Entries are sought from British-based architects, and from architects throughout the world for built projects in the UK. In past years this broad mix has resulted in winning projects from, amongst others, the offices of DeRijke Marsh Morgan, Foster & Partners, Rick Mather, Zaha Hadid, Allford Hall Monaghan Morris, Sauerbruch Hutton, Will Alsop and David Chipperfield.

In parallel with the professional awards the Chapter has chosen to recognise future talent through the **Noel Hill Student Travel Awards Programme**. Two cash awards totalling £2000 are given.

The Jury completed deliberations in early March. Members this year covered a wide range of interests; academic, professional practice, engineering and development. Members included Simon Conder, Peter Salter, Edward Cullinan, Chris Wilkinson, Tim Macfarlane, Roger Zogolovitch and Andrew Orgorzalek.

2004 Wining Projects

- 1) No.1 Centaur Street
De Rijke Marsh Morgan
- 2) Black Rubber House
Simon Conder Assoc
- 3) Bridge of Aspiration
Wilkinson Eyre Architects
- 4) Jubilee School
Allford Hall Monaghan Morris
- 5) Butterfly House (highly commended)
Chetwood Associates (not shown)

member profile

a snapshot

Jim Baker, FAIA President

Jim started commuting from New York to London in the late '80s to pursue an opportunity capitalising on his interest in prefabricated housing. In 1994 he founded The Forge Company (UK) Ltd, a specialist design-build subcontractor for prefabricated light gauge steel residential structures and was its chief executive for ten years. He became a UK resident in 1997 and lives in Greenwich and East Sussex with his partner Jill Jackson. His work in the UK has been primarily associated with the housing sector. Although Jim is now 'semi-retired', he is busy writing a book on light gauge steel construction in collaboration with the Steel Construction Institute and continuing to provide architectural service to several long standing US clients.

Jim has been a London / UK chapter member since 1996 and joined the Board in 2002. Before coming to the UK Jim was active in the New York Chapter of the AIA and served as a Chapter officer, an Institute Director from New York and a trustee of the AIA Foundation. He is a Richard Upjohn Fellow, having been elected to the College of Fellows in 1976.

In addition to managing his architectural practice Jim was a founding trustee and, for ten years, President of Mount Lebanon Shaker Village, an organisation designed to preserve this designated World Heritage Site. He is a trustee of the Darrow School in New Lebanon, New York and serves on the advisory council of the Shaker Museum and Library of Chatham, New York.

AIA International Committee

Chapter member Michael Lischer has accepted an invitation to serve as one of five members on the Steering Group of the AIA's International Committee. Michael's term is for four years and he welcomes any comments or suggestions that you may have.

The IC, formerly known as the International Professional Interest Area, is one of 27 committees in what is now referred to as the AIA Knowledge Community. The purpose of the IC is to:



- Promote excellence in the international practice of architecture.
- Serve as a resource for information on international markets, practice, and design.
- Provide expertise in international policy and trade issues.
- Enhance international practices of the membership and foster relationships with architects abroad.

Michael says, "My goal by serving on the Steering Group is to raise the profile of international practice within the AIA, forge a closer relationship among the three international chapters, and create an even stronger rapport for the London/UK Chapter with AIA National's executive staff and board of directors".

Knowledge Community Awareness

Those of you who attended David Harris's presentation on February 23rd of Nicholas Grimshaw and Partners' new 55,000m² factory at Goodwood for Rolls-Royce Motor Cars will have learned some interesting facts about the design of the superbly crafted building as well as the Rolls Royce Phantom which is assembled there. This was the first event in the Chapter's 2005 series offering AIA CES Learning Units under our new CES Director Kristy Sels, AIA. If you missed it, and even if you didn't, it is worth reading Kenneth Powell's article about the project and the other design consultants' contributions to it in *The Architects' Journal* issue February 5th 2004. There will be many more events to follow and to stay informed about the next one log on to www.aiauk.org and click on Calendar.

Now for my main topic. If you read the articles in the latest AIA Journal for Architecture published November 2004, available at www.aia.org/aiaj_nwsltr_current, you will have noted the increased emphasis within the profession on Knowledge Communities and Knowledge Constituencies, previously referred to as PIAs or Professional Interest Areas. Becoming active in these groups and tapping the information available from them focuses our continuing education awareness and improves our motivation to stay involved. Extensive information about AIA Knowledge Communities is available on-line via links at www.org/nav_kc which you can easily print out; and don't forget, you can shop on-line for PIA books at the AIA Store at the same time too.

Harry Goforth

architecture at the V&A + On Foot in London

Architecture at the V&A

AIA London has organised a private tour of the V & A architecture galleries starting at 7PM on Wednesday 13th April. The tour will be limited to 25, cost £10 to non-members. Please RSVP to info@aiauk.org unless otherwise notified a place will be held for you.

Drawing from the unparalleled collections of the RIBA and the V&A, the new Architecture gallery explores this amazing subject through original drawings, models, photographs and building fragments. From Classical Rome to the 21st century, from East to West, and from the everyday 'semi' to the landmark building.

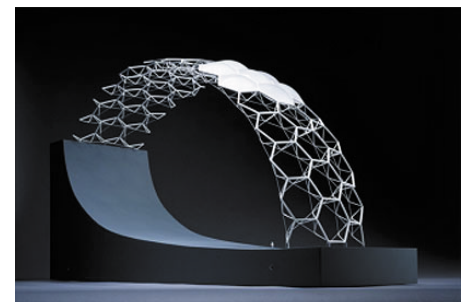

Timber Framed Buildings that Survived the Great Fire

Meet at 11am Saturday the 11th of June at St. Bartholomew the Great Church, Smithfield, London. RSVP as above.

The guide and commentator for this outing is Benedict O'Looney, Architect and Lecturer in Architecture History at the Architectural Association. This tour explores the small but intense collection of sixteenth century houses, just outside the City of London which have survived both the Fire of London, and the re-development of Holborn in the nineteenth and twentieth centuries. These houses are a vivid insight into London's picturesque Renaissance townscape consumed by the Great Fire.

Benjamin Franklin House

Countdown to Opening - 11 months to go

The Ben Franklin House (BFH) has been the home of AIA London for some years now, an association which was recently re-confirmed. BFH will be expending just over £1.5 million between now and opening in 2006 on conservation and infrastructure. The project is supported by the Historical Heritage Lottery Fund and the Architectural Heritage Fund. In addition a prominent US donor has issued a challenge toward outstanding project costs and the creation of a £1 million endowment fund to further the aims of the House and secure its future.

The following report from Márcia Balisciano, Director of Ben Franklin House, summarises current activities on the redevelopment of 36 Craven Street.

February began with an important session at Craven Street to advance sound, lighting and design plans for the Historical Experience. We are making good progress on integrating the exciting 21st century technology with the 18th century fabric of the building required for the

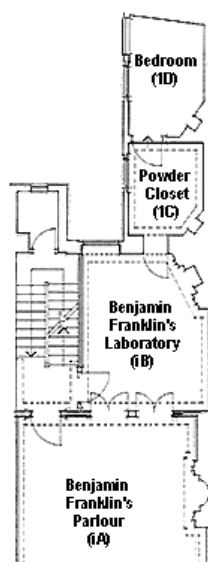

First Floor Plan of Ben Franklin House

Historical Experience, which will be the public's primary interface with Benjamin Franklin House. This is a challenge Ben would have relished. After all, to paraphrase his statement on his electrical work, 'I was born 200 years too soon, something will be made of all this!' The museum-as-theatre Historical Experience, which has been well received in the extensive consultations we have undertaken, will be fresh and engaging and remove the traditional distance between visitor and history by creating a virtual stage in each of the historic rooms. It will present the excitement and uncertainty of Franklin's London years using the rooms he inhabited for nearly sixteen years as staging for a drama which seamlessly integrates

live performance, and cutting-edge lighting and projection technology, establishing, we believe, a new standard for historical interpretation.

If you have any ideas or wish to lend support for the £1 million endowment challenge, please email BenjaminFranklinHouse@msn.com.

Tsunami Relief Donation

by AIA London / UK

At the January meeting of the AIA London / UK Board a donation of £500 was approved to **Habitat for Humanity** in support of their relief efforts related to the Asian Tsunami.

AIA Continental News

Spring Event

Join AIA Continental Europe Chapter at their annual conference, May 26-29, 2005. This year in Helsinki



Helsinki's
Exceptional
Architecture: What,
Who, Where, Why?

Up to 16 AIA/CES
Learning Units

For a description, program details, and registration, go to www.aiaeurope.org Early registration ends April 11. Questions? Contact Tamara Kwist at administration@aiaeurope.org

Chapter Sponsors

Call Print
www.callprint.com

Herman Miller
www.hmeurope.com

Lutron Lighting Control
www.lutron.com

Mace Limited
www.mace.co.uk

Schneider
www.schneider-facades.co.uk
www.schneider-fassaden.de